

# SL20-22P VENETIAN

## KNOB

This is a magnetic system with manual blind control. The system is designed to enable slat rotation through an external knob, which is attached to the window/door frame.

The internal magnetic unit responsible for transferring the knob's movement to the blinds is completely concealed and sealed within the insulated glass unit. This ensures the insulated glass unit's properties, particularly protection against dirt and weather conditions.

The SL20-22P system is supplied as standard with a 20mm or 22mm warm spacer bar in gray (RAL7035) or black (RAL9005).



### CONTROL SYSTEM COLORS



### SLATS COLORS

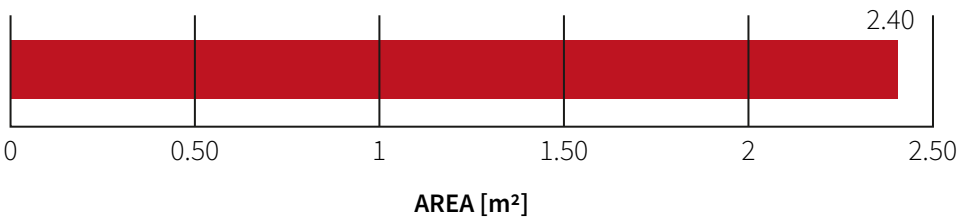
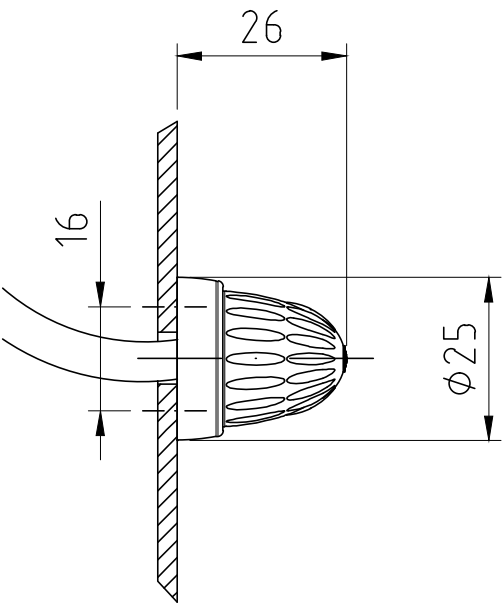
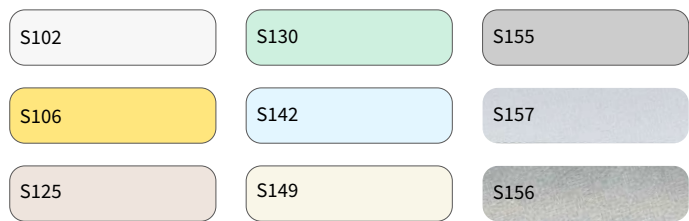

### POSSIBLE DIMENSIONS

MINIMUM DIMENSION		MAXIMUM DIMENSION	
WIDTH	HEIGHT	WIDTH	HEIGHT
190mm	300mm	2000mm	2500mm

